

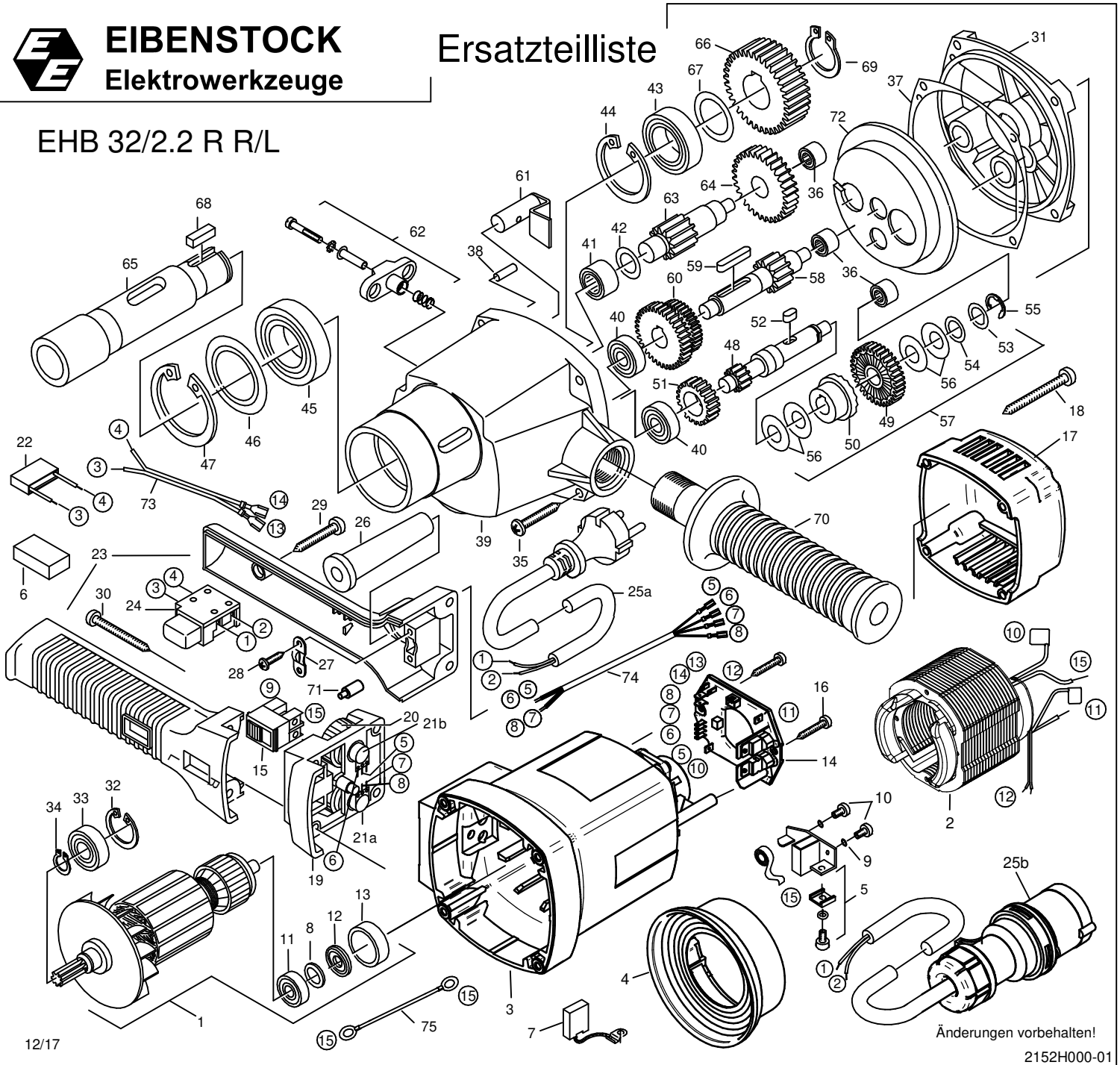

EIBENSTOCK
Elektrowerkzeuge

Ersatzteilliste

EHB 32/2.2 R R/L





0152H000

EHB 32/2.2 R R/L - 230V

Version: 01

Dated: 07.12.2022

Pos.	Description	Item No.	pc.
1	Rotor, compl. 230V	74326100	1
2	Stator, compl. 230V	74326150	1
3	Motor housing	80900042	1
4	Air guiding ring	71540144	1
5	Brush holder, compl.	80201199	2
6	Foam filler	80600306	1
7	Carbon brush 6,3x16x20	80700021	2
8	Fibre washer 10x14x0,5	80200998	1
9	Spring washer 4	80201385	4
10	Screw M4x12	80201180	4
11	Grooved ball bearing 6000 2Z	80410021	1
12	Magnetic ring 24x10x4,8	80701004	1
13	Bearing cap	83000031	1
14	Printed circuit board 230V	80601137	1
15	Switch	80600103	1
16	Screw 4,2x9,5	80201269	2
17	Cap	80900082	1
18	Screw 4,8x45	80201267	4
19	Intermediate part	80901002	1
20	Adjusting wheel	80900290	2
21b	Potentiometer 1 kOhm	80500007	1
21a	Potentiometer 100 kOhm	80500020	1
22	Capacitor	80500010	1
23	Pair of handle halves	71527260	1
24	Switch	80600102	1
25a	Connecting cable 2x1mm ² 3m	80600060	1
26	Cable grommet	83000004	1
27	Wire locking flange	85000020	1
28	Screw 4,2x16	80201271	2
29	Screw 5,5x32	80201291	1
30	Screw 5,5x50	80201294	4
31	End shield of gearing	7152H610	1
32	Retaining ring 28x1,2	80201333	1
33	Grooved ball bearing 6001 2RS	80410032	1
34	Retaining ring 11x1	80201320	1
35	Screw 5,5x38	80201292	4
36	Needle sleeve HK0810	80420110	3
37	Gearbox seal	82000509	1
38	Grooved pin 5x16	80200580	1
39	Gearbox housing	7152H400	1

Pos.	Description	Item No.	pc.
40	Grooved ball bearing 6000	80410020	2
41	Needle bearing RNA 4900	80420001	1
42	Disc	71540517	1
43	Grooved ball bearing 6005 2RS	80410061	1
44	Retaining ring 47x1,75	80201336	1
45	Grooved ball bearing 6006 2RS	80410071	1
46	Disc	71540426	1
47	Retaining ring 55x2	80201338	1
48	Intermediate shaft 1	71521490	1
49	Clutch wheel	74326550	1
50	Coupling half	71540560	1
51	Intermediate wheel 1	71521470	1
52	Parallel key 5x5x10	80200600	1
53	Pressure washer 12,1x18x1	71540606	1
54	Pressure washer	71540607	2
55	Safety washer 9	80201361	1
56	Disc spring 25x12,2x0,9	80200710	4
57	Clutch, compl.	7152H49K	1
58	Intermediate shaft 2	71521500	1
59	Parallel key 5x5x28	80200602	1
60	Gear block	71521440	1
61	Coupling bolt	71521520	1
62	Gear changer, compl.	7154A545	1
63	Intermediate shaft 3	71521510	1
64	Intermediate wheel 2	71521480	1
65	Drilling spindle	74527420	1
66	Spindle wheel	71540430	1
67	Shim ring 25x35x0,1	80200512	1
68	Parallel key 6x6x20	80200606	1
69	Retaining ring 24x1,2	80201326	1
70	Tube handle, compl.	7154C590	1
71	Bolt	7152H366	1
72	Grease compartment barrier	80900111	1
73	Interconnecting wire	7152B184	1
74	Interconnecting wire	7152B186	1
75	Interconnecting wire	80600243	2