

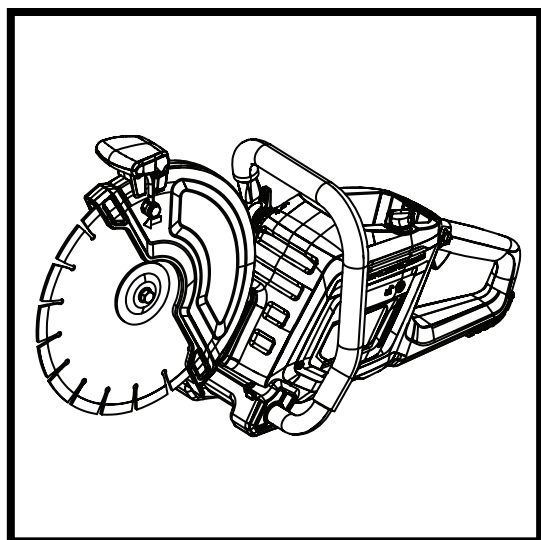

BELLE DC 300E+

870/30014/3
03/25



ⒼⒷ Operators Manual

UKCA Declaration of Conformity

Declaration Of Conformity (DOC)

We, **Altrad Belle, Sheen, Nr. Buxton, Derbyshire, SK17 0EU, GB** declare that the DoC is issued under our sole responsibility and belongs to the followings product(s):



PRODUCT TYPE
MODEL.....
SERIAL No.....
DATE OF MANUFACTURE
SOUND POWER LEVEL
MEASURED /
.....(GUARANTEED)
WEIGHT.....



Object of the Declaration:

Battery powered disc cutter for cutting various types of hard materials such as concrete, stone, masonry and steel.

The object of the declaration described above is in conformity with the relevant **Statutory Requirements**:

- **2008 No. 1597** Supply of Machinery (Safety) Regulations 2008
- **2001 No. 1701** Noise Emission in the Environment by Equipment for use Outdoors Regulations 2001
- **2016 No. 1091** Electromagnetic Compatibility Regulations 2016
- **2012 No. 3032** The Restriction of the Use of Certain Hazardous Substances in Electrical and Electronic Equipment Regulations 2012

The following designated standards and technical specifications have been applied:

- **EN ISO 12100:2010**
- **BS EN 62321-3-1, BS EN 62321-4, BS EN 62321-5, BS EN 62321-6, BS EN 62321-7-1, BS EN 62321-7-2 & BS EN 62321-8**
- **ISO 3744:2010**
- **BS EN 62841-1**
- **BS EN 55014-1, BS EN 55014-2**

Technical Files are held by **Ray Neilson** at the Altrad Belle address stated above:-

Place of Declaration:-

Sheen,
Nr. Buxton,
Derbyshire,
SK17 0EU,
UK

Date of Declaration:-

March 2024

Signed by:

Ray Neilson

Managing Director
On behalf of Altrad Belle
Sheen, Derbyshire, UK



EC Declaration Of Conformity (DOC)



We, **Altrad Belle, Sheen, Nr. Buxton, Derbyshire, SK17 0EU, GB** declare that the DoC is issued under our sole responsibility and belongs to the followings product(s):



PRODUCT TYPE

MODEL.....

SERIAL No.....

DATE OF MANUFACTURE

SOUND POWER LEVEL
MEASURED /
.....(GUARANTEED)

WEIGHT.....

Signed by:

Ray Neilson

Managing Director

On behalf of Altrad Belle, Sheen, Derbyshire, UK

Place of Declaration:-

Sheen, Nr. Buxton, Derbyshire, SK17 0EU, UK

Date of Declaration:-

March 2024

Object of the Declaration:

Battery powered disc cutter for cutting various types of hard materials such as concrete, stone, masonry and steel.

The object of the declaration described above is in conformity with the relevant **Union Harmonisation Legislation**:

- **2006/42/EC** - New machinery directive

- **2000/14/EC** - Noise - equipment for use outdoors

The following harmonised standards and technical specifications have been applied:

- **EN ISO 12100:2010**

- **BS EN 62321-3-1, BS EN 62321-4, BS EN 62321-5, BS EN 62321-6, BS EN 62321-7-1, BS EN 62321-7-2 & BS EN 62321-8**

- **ISO 3744:2010**

- **BS EN 62841-1**

- **BS EN 55014-1, BS EN 55014-2**

Technical Files are held by **Armand Trenel** at the following address:-

Altrad Investment Authority SAS: 150 Rue Le Pérugin, 34000 Montpellier, France.



EU Declaration Of Conformity (DOC)



We, **Altrad Belle, Sheen, Nr. Buxton, Derbyshire, SK17 0EU, GB** declare that the DoC is issued under our sole responsibility and belongs to the followings product(s):



PRODUCT TYPE

MODEL.....

SERIAL No.....

DATE OF MANUFACTURE

SOUND POWER LEVEL
MEASURED /
.....(GUARANTEED)

WEIGHT.....

Signed by:

Ray Neilson

Managing Director

On behalf of Altrad Belle, Sheen, Derbyshire, UK

Place of Declaration:-

Sheen, Nr. Buxton, Derbyshire, SK17 0EU, UK

Date of Declaration:-

March 2024

See information
on sticker above

Object of the Declaration:

Battery powered disc cutter for cutting various types of hard materials such as concrete, stone, masonry and steel.

The object of the declaration described above is in conformity with the relevant **Union Harmonisation Legislation**:

- **2014/30/EU** - EMC Directive

- **2011/65/EU** - Restriction of Hazardous Substances Directive

The following harmonised standards and technical specifications have been applied:

- **EN ISO 12100:2010**

- **BS EN 62321-3-1, BS EN 62321-4, BS EN 62321-5, BS EN 62321-6, BS EN 62321-7-1, BS EN 62321-7-2 & BS EN 62321-8**

- **ISO 3744:2010**

- **BS EN 62841-1**

- **BS EN 55014-1, BS EN 55014-2**

Technical Files are held by **Armand Trenel** at the following address:-

Altrad Investment Authority SAS: 150 Rue Le Pérugin, 34000 Montpellier, France.



Contents

<u>CONTENTS</u>	<u>PAGE NUMBER</u>
UKCA DECLARATION OF CONFORMITY	2
EC/EU DECLARATION OF CONFORMITY	3
INTRODUCTION.....	11
WARNING	11
Serial Numbers.....	11
MACHINE DESCRIPTION	
General.....	12
Standard Operation	12
Danger Zone	12
Main Components Locations.....	13
TECHNICAL DATA	14
Static Dimensions.....	14
General Data	15
Battery	15
Battery Charger	15
SAFETY INSTRUCTIONS	
General.....	16
Pre-Start Checks	16
Worksites.....	16
Transportation	16
Operating the Machine	17
Battery Pack	17
Battery Charger	18
Blades	18
Transportation and Storage.....	19
Weather Conditions	19
During Maintenance	19
After Maintenance	19
Modifications & Replacement Parts	19
Safety Decals	20
OPERATING INSTRUCTIONS	
Charging the Battery Pack	21
Installing the Blade	22
Adjusting the Blade Guard	22
Inserting the Battery	23
Removing the Battery	23
Function of Control Panel.....	23
Holding the Machine.....	23
Connect the Water Supply	24
Trigger Lock-Out Button	24
Starting the Machine	24
Stopping the Machine.....	24
Operating Principals	25 - 26
LED Light.....	26
STORAGE.....	27
ENVIRONMENT	27
SERVICE AND MAINTENANCE	
General.....	28
Maintenance Schedule.....	28
Cleaning	29
Replacing the Blade	29
Troubleshooting Guide	30
WARRANTY	31
REPLACEMENT PARTS	31

Introduction



The purpose of this publication is to enable the owner/operator to maintain and use the tool efficiently. If these instructions are followed carefully they will contribute to years of efficient and profitable operation of the tools in the true Altrad Belle tradition.

The variations in operating conditions make it impossible for the company to make comprehensive or definite statements in its publications regarding performance and methods of use of its tools, or to accept any liability for any loss or damage which may result from these statements, or from any errors or omissions.

When replacements are required, insist on genuine Altrad Belle parts, as extensive damage is liable to result from the use of inferior quality parts.

In accordance with the company's policy of continuous improvement to its tools, alteration to the specifications of tools may be made at any time without notice and the company accepts no responsibility for any discrepancies which may occur between the specifications of its tools and the descriptions thereof contained in this publications.

This manual has been written to include all factory fitted options and specifications for world-wide use, but this does not imply that all or any of these are included in the standard tool configuration. Therefore local Altrad Belle Dealer's must always be consulted about tool specifications.

This manual may not in part, or in whole, be copied, photocopied, reproduced, translated, or converted to any electronic or tool readable form without written consent of Altrad Belle.

Directives with regard to the notations.

Text in this manual to which special attention must be paid are shown in the following way:



CAUTION

The product can be at risk. The tool or yourself can be damaged or injured if procedures are not carried out in the correct way.



WARNING

The life of the operator can be at risk.

WARNING



WARNING

*Before you operate or carry out any maintenance on this tool **YOU MUST READ** and **STUDY** this manual.*

KNOW how to safely use the unit's controls and what you must do for safe maintenance. (NB Be sure that you know how to switch the tool off before you switch on, in case you get into difficulty.)

ALWAYS wear or use the proper safety items required for your personal protection. If you have **ANY QUESTIONS** about the safe use or maintenance of this unit, ASK YOUR SUPERVISOR OR CONTACT: **Altrad Belle (UK): +44 (0) 1298 84606**

Serial Numbers



ENSURE you make a note of the serial numbers of your tool and always quote them in any communication with Altrad Belle or one of our dealers.

A - MACHINE SERIAL NUMBER

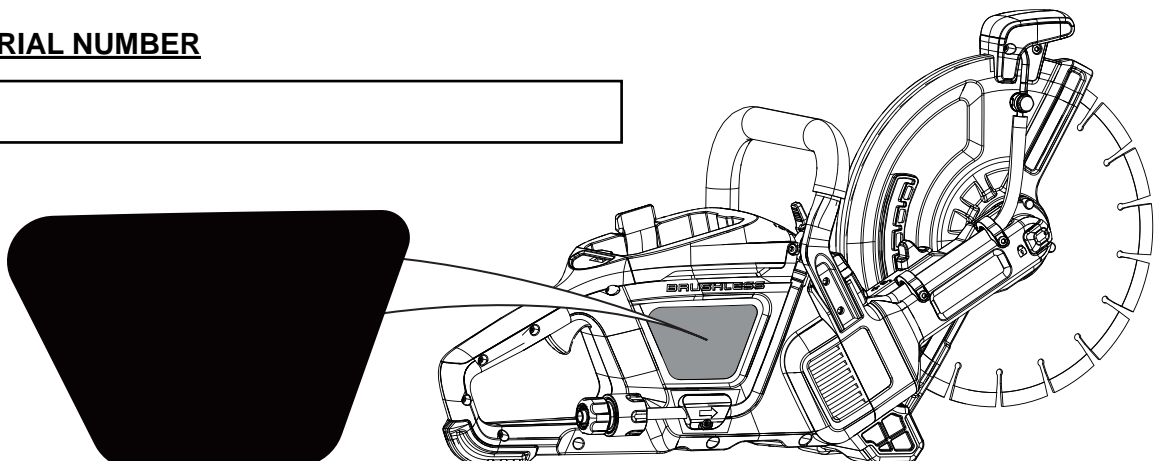



Machine Description

GENERAL

The Altrad Belle DC 300E+ emission free, Li-ion battery-powered disc cutter is designed for the purpose of cutting various types of hard materials such as concrete, stone, masonry and steel.

STANDARD OPERATION

The tool is intended to be used for the following, in safe environmental conditions as described in this manual.

- Concrete / Concrete Blocks / Stone / Tarmac
- Metal

Any other use is not deemed suitable for this tool. Altrad Belle will not be liable for any damage or injury resulting from any use other than outlined above. The operator will be liable.

Any unauthorised modifications or attachments are prohibited. They may affect the performance and safety of the tool, potentially resulting in damage to the tool or injury to the operator.

Use of non-genuine blades or replacement parts may also affect the performance and safety of the tool, potentially resulting in damage to the tool or injury to the operator.

DANGER ZONE

The danger zone is the area around the tool in which persons are endangered during standard operation as outlined above.

During operation of the tool, cordon off the work area and keep members of the public and unauthorized personnel at a safe distance away from the danger zone.

MAIN COMPONENT LOCATIONS

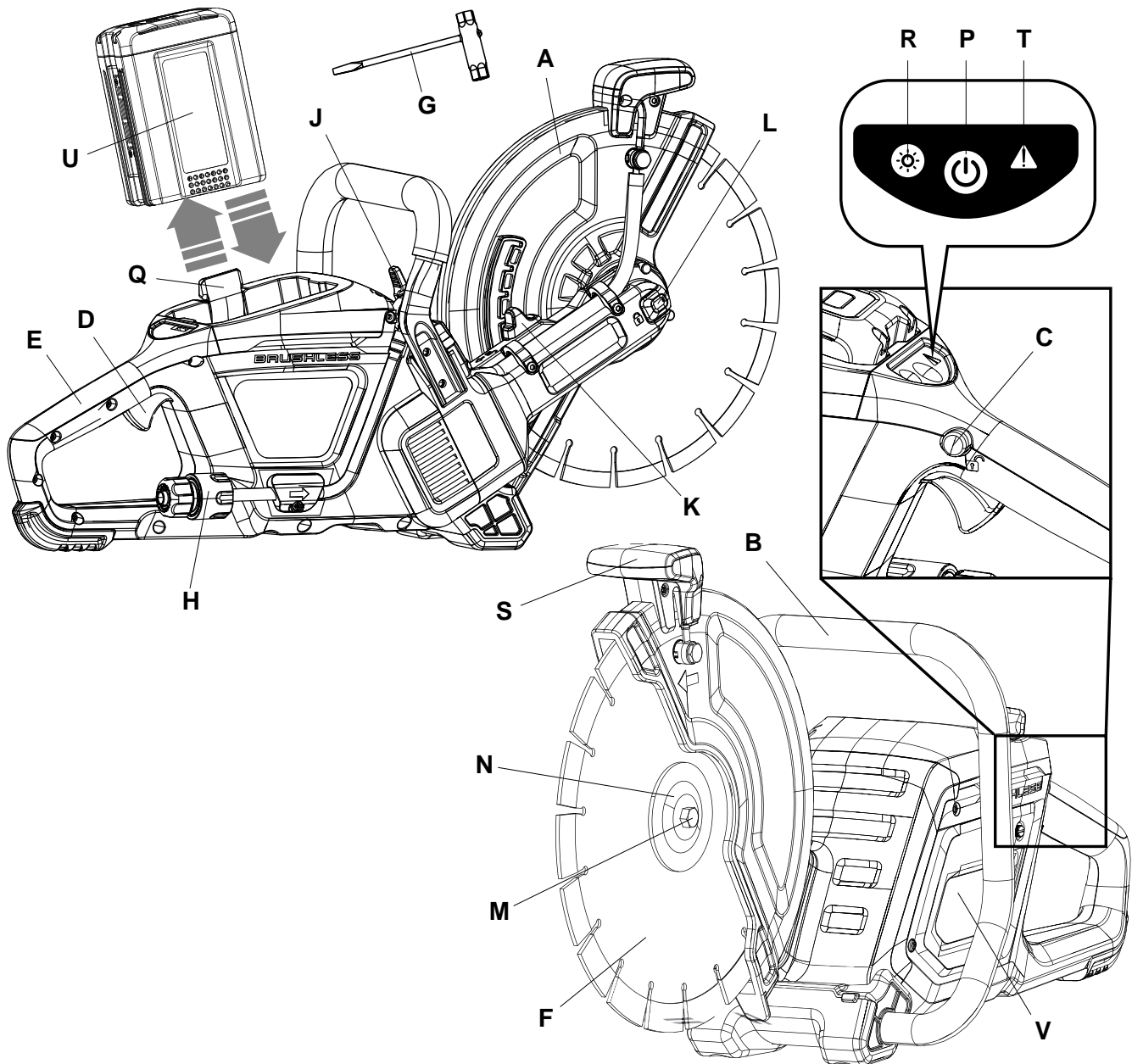

- A. Blade Guard.
- B. Front Handle.
- C. Trigger Lock-Out Button.
- D. Trigger.
- E. Rear Handle.
- F. Cutting Blade.
- G. 13mm Spanner.
- H. Water Feed Coupling.
- J. Water Flow Valve.
- K. Guard Adjustment Lever

- L. Spindle Lock Button.
- M. Blade Securing Screw.
- N. Blade Clamping Plate.
- P. On / Off Button
- Q. Battery Release Latch.
- R. LED Light On / Off Button.
- S. LED Light.
- T. Warning Light.
- U. Battery
- V. Magnetic Filter Cover

STATIC DIMENSIONS

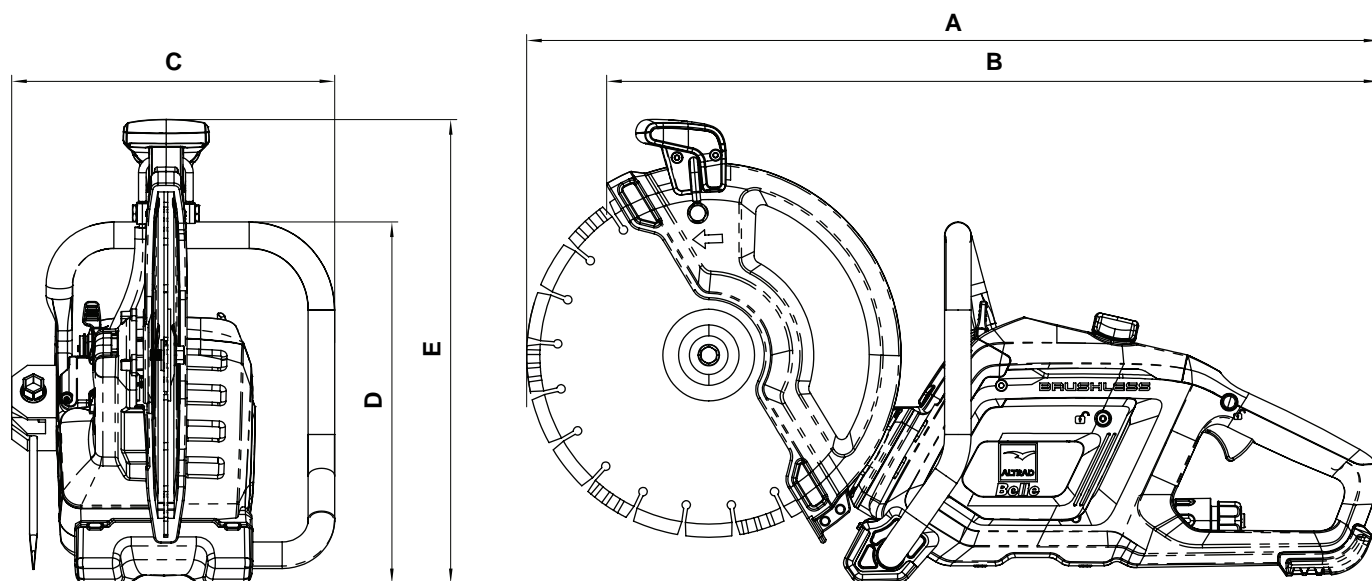

Model	DC 300E+
A - Length with Blade (mm)	706
B - Length without Blade (mm)	640
C - Width (mm)	268
D - Height to Handle (mm)	300
E - Overall Height (mm)	385

GENERAL DATA

Model	DC 300E+
Voltage (v)	82
Cutting Speed (rpm)	5400
Blade Outside Diameter (mm)	300
Blade Bore Diameter (mm)	20 or 25.4
Blade Tightening Torque (Nm)	25
Max. Depth of Cut (mm)	112
Max. Water Supply Pressure (bar)	6
*Weight (Kg)	5.7
Sound Power Level (dB L _{WA})	114
3 Axis Vibration - Main Handle (m/sec ²)	< 2.5
3 Axis Vibration - Auxiliary Handle (m/sec ²)	2.6

* Weight does not include battery or blade.

BATTERY

Model	8Ah Battery	5Ah Battery
Model Code	OPM/14/FIO	OPM/13/FIO
Battery Type	Li-Ion	Li-Ion
Weight (kg)	3.9	2.8
Dimensions L x W x H (mm)	120 x 90 x 240	120 x 90 x 214
Max. Voltage (v)	82	82
Nominal Voltage (v)	72	72
Energy Rating (Wh)	580	360
Energy Capacity (Ah)	8	5
80% Charge Time (Mins)	Approx. 48	Approx. 28
100% Charge Time (Mins)	Approx. 65	Approx. 39

BATTERY CHARGER

Model	Battery Charger
Model Code	OPM/16/FIO
Dimensions LxWxH (mm)	230 x 170 x 170
Weight (kg)	2.0
Input Voltage AC (v)	230v
Input Frequency (Hz)	50 / 60
Output voltage DC (v)	82
Output current (A)	8

GENERAL SAFETY

For your own personal protection and for the safety of those around you, please read and ensure you fully understand the following safety information. It is the responsibility of the operator to ensure that he/she fully understands how to operate this equipment safely. If you are unsure about the safe and correct use of the tool, consult your supervisor or Altrad Belle.



WARNING

Improper maintenance can be hazardous. Read and Understand this section before you perform any maintenance, service or repairs.

This tool is designed to eliminate the possible risks arising from the use of it. However, risks **DO** reside, and these residual risks are not clearly recognizable, and may cause personal injury or property damage, and possible death. If such unpredictable and unrecognizable risks become apparent, the tool must be stopped immediately, and operator or his supervisor must take appropriate measure to eliminate such risks. It is sometimes necessary that the manufacturer must be informed of such event for future counter measuring.

ALWAYS keep the Operator's Manual and any other manuals that accompany this tool to hand. Immediately replace any manuals that may have been lost or are now illegible.

PRE-START CHECKS

The following Pre-start-up inspection must be performed before the start of each work session or after every four hours of use, whichever is first. Please refer to the service section for detailed guidance. If any fault is discovered, the tool must not be used until the fault is rectified.

1. Carefully read through and understand the operators manual.
2. Thoroughly inspect the tool for signs of damage. Check components are present and secure.
3. **ENSURE** all packaging material has been removed before operating.
4. **ENSURE** there is no debris or excessive dirt present on the tool.
5. **DO** replace any worn/damaged warning decals.
6. **ENSURE** the battery pack is securely inserted into the battery slot.
7. **ENSURE** the battery pack is sufficiently charged.
8. **DO NOT** use the battery if it shows signs of damage/wear or if it is leaking fluid. In this case place the battery in a secure location away from flammable materials and arrange for safe disposal.
9. **ENSURE** the water connector is connected to a water supply for dust suppression (see page 16)
10. Check blade condition.
11. Check that the correct blade has been selected for the material being cut.
12. Check the blade guard is fitted and set correctly.
13. Check the blade securing bolt is tightened correctly.

Once all the above checks have been made, test run the tool checking that all switches function correctly and all indicators light when the power unit is turned on.

WORKSITES

- **ENSURE** the operator is familiar with the working surroundings. Worksites can be hazardous.
- **ALWAYS** keep the work area tidy and clear of any obstructions that may lead to accidents and/or injuries.
- **ENSURE** the work area is well lit with no dark areas.
- Cordon off the work area and keep members of the public and unauthorized personnel at a safe distance.
- Check that the area is suitable for cutting the materials. Sparks, hot particles, metallic particles and dust could be produced when cutting.
- Check that no combustible fluids, materials or gasses are in the cutting area.

TRANSPORTATION

- **ENSURE** the machine is securely stored during transportation to reduce the risk of damage and injuries occurring.
- **ALWAYS** remove the blade from the machine before transportation.
- **ALWAYS** remove the battery from the machine before transportation.

OPERATING THE MACHINE

- **ENSURE** the operator has had adequate training prior to use, is familiar with all controls and knows how to safely switch the tool **OFF** before it is switched **ON** in case you get into difficulty.
- **NEVER** allow children to operate this product.
- Suitable PPE **MUST** be worn when using this equipment i.e. Safety Goggles, Gloves, Ear Defenders, Dust Mask and Steel Toe capped footwear (with anti-slip soles for added protection). Wear clothing suitable for the work you are doing and **DO NOT** wear loose jewellery that could be caught in moving parts.
- **ALWAYS** inform colleagues of what you will be doing and where you will be working.
- **DO NOT** operate the tool when you are ill, feeling tired, or when under the influence of drugs / alcohol.
- **ENSURE** the blade stops completely before setting the power tool down.
- **NEVER** leave the saw running whilst unattended or whilst carrying across the work area / work site.
- **NEVER** remove or tamper with any guards fitted, they are there for your protection. Always check guards for condition and security, if any are damaged or missing, **DO NOT USE THE TOOL** until the guard has been replaced or repaired.
- **ENSURE** the ON/OFF switch is in the OFF position before connecting the battery to prevent unintentional start-up.
- **DO NOT** over-reach when operating the tool. **ALWAYS** keep a stable footing with both feet on the ground.
- **NEVER** become complacent or over-familiar with the operating process and ignore general operating safety.
- **NEVER** force the tool. **ALWAYS** use the most suitable tool for your application.
- **DO NOT** use the machine if the ON/OFF switch is faulty. This **MUST** be repaired before use.
- **ENSURE** the operating handles are clean, dry and free from grease/oil.
- **KEEP** the blade sharp and clean.
- **ENSURE** there are no gas pipes or electrical cables in the cutting area. If any are detected, they **MUST** be clearly marked.
- **NEVER** operate the tool in the vicinity of flammable materials. The operating process may produce sparks.
- **ALWAYS** use a blade that is within the rated capacity of the tool (see Technical Data section)
- **ALWAYS** hold the insulated gripping surfaces of the tool when performing an operation that may contact hidden wiring.
- **ALWAYS** ensure the dust is adequately removed during dry cutting.

Kickback

A kickback is an abrupt response to a spinning blade that has been pinched or snagged that causes the blade to stall rapidly, forcing the powered tool in the opposite direction of the blade's revolution, at the point of snagging.

- **KICKBACK** is caused by improper use of the tool, improper operating conditions, and/or operating methods. It can be prevented by following the correct operating procedures as listed below.
 - **ENSURE** the operator maintains a firm grip on the tool throughout operation to resist kickbacks.
 - **AVOID** holding the saw in front of your body, hold to the side.
 - **ALWAYS** take extra care when working corners, sharp edges or intricate cuts.
 - **DO NOT** apply excessive pressure onto the blade.
 - **WHEN/IF** the blade is snagged, turn off the tool and allow the blade to stop rotating. Remove the tool from the cut and investigate the cause of snagging. **DO NOT** operate the tool until the cause has been sorted.
 - **DO NOT** restart the tool within the cut. **ALWAYS** allow the blade to reach full speed before re-entering the cut.
 - Support oversized or heavy panels to prevent sagging. Sagging may increase the chance of snagging and kickback.
- See more information on kickback on Page 17 & 18.**

BATTERY PACK

- **ALWAYS** use a genuine battery pack that is intended for this machine.
- **DO NOT** disassemble the battery pack.
- **DO NOT** touch the Battery Pack's connectors with metal objects or insert metal objects through openings into the Battery Pack.
- **ALWAYS** keep the battery pack clean and dry.
- **NEVER** allow the battery pack to come into contact with water.
- If the Battery Pack leaks fluid or smells strangely, **IMMEDIATELY** move it away from any heat sources or flame. There is a risk of fire or rupturing if the leaked liquid or gas ignites.
- The Battery Pack contains combustible organic solvents as an electrolyte solution. If the liquid gets into your eyes, rinse them with plenty of water. After that, **IMMEDIATELY** seek medical care. (See Safety Data Sheet).
- **DO NOT** allow children to use the Battery Pack. Store the Battery Pack out of the reach of children.
- **DO NOT** store the Battery Pack in a damp location. Doing so can cause a malfunction.
- When the Battery Pack is not in use, keep it away from other metal objects like coins, keys, nails, screws or other small metal objects that can make a connection from one terminal to another. Shorting the battery terminals together may cause burns or a fire.
- In case of fire, **STOP** using the machine immediately and extinguish with dry chemical, sandy soil, carbon dioxide or appropriate foam.
- The Battery Pack will deteriorate if it is repeatedly charged and discharged, as well as if it is stored and not used.
- As the Battery Pack deteriorates, its full-charge capacity decreases and the length of time it can be used shortens. Once the full-charge capacity is reduced by deterioration, it cannot be recovered and cannot reach the charging capacity of a new Battery Pack.
- **ALWAYS** remove the battery pack from the power unit when transporting or maintaining it.
- **ONLY** charge the battery pack in a recommended charging unit.
- **DO NOT** expose the battery pack to extreme temperatures (below -14°C (6.8°F) or above 40°C (104°F))
- **NEVER** attempt to service a damaged battery pack.
- **WORK ON THE BATTERY PACK OR POWER UNIT MUST ONLY BE CARRIED OUT BY SUITABLY COMPETENT & QUALIFIED PERSONNEL**

BATTERY CHARGER

- To reduce the risk of injury, **ONLY** charge Cramer 82v BAB733, BAB735 & BAB737 type rechargeable batteries. Other types of batteries may burst causing personal injury and damage.
- This Battery Charger is not intended for use by children or persons with physical, sensory or mental limitations or a lack of experience or knowledge. **DO NOT** allow children to play with this Battery Charger - **IT IS NOT A TOY!**
- Charge only Li-ion Battery Packs that do not exceed a capacity of 8AH 82v. The battery voltage must match the battery charging voltage of the Battery Charger. **DO NOT** charge non-rechargeable Battery Packs, otherwise there is danger of fire and explosion.
- Continued use of the Battery Charger under unusual conditions could result in fire or electric shock, which may kill or seriously hurt you.
- **DO NOT** modify the Battery Charger. Modifying, disassembling or repairing the Battery Charger could result in fire or electric shock, which can cause death or serious injury. Disassembly and repairs require specialised knowledge, contact your servicing dealer.
- Before using the Battery Charger / charging a Battery Pack, people who are using an electronic medical devices must confirm how their device might be affected. The electromagnetic radiation produced during charging may affect the operation of electronic medical devices, which may kill or seriously hurt you.
- If the Battery Pack leaks fluid or smells strangely, stop using it and contact your servicing dealer. Battery Pack contains combustible organic solvents as an electrolyte solution. Mistakenly handling them may result in burns or serious injuries (See Safety Data Sheet).

DO NOT use the Battery Charger in the following situations.

- Locations where the Battery Charger becomes unstable.
- Locations where there is flammable gas or combustible materials
- Locations that are very cold or very hot, such as in direct sunlight or near a heater
- Locations exposed to water or excessive humidity
- Locations where children or pets might play with it

ALWAYS follow the rules below.

- **DO NOT** charge Battery Packs if there is the risk of a lightning storm.
- **DO NOT** charge if the electric outlet is loose.
- **DO NOT** charge if the Battery Charger, AC cable, or the electric outlet is damaged or deformed, dusty, dirty, or rusty.
- **DO NOT** plug too many power cords into one electric outlet.
- **DO NOT** charge while the AC cable is wound up.
- **DO NOT** stand on or place heavy objects on the Battery Charger or AC cable.
- **DO NOT** pull or repeatedly bend the AC cable or charging cable with an excessive force.
- **DO NOT** touch the Battery Charger or AC cable if your hands are wet.
- **DO NOT** splash or submerge the Battery Charger or AC cable in water.
 - If the Battery Charger or AC cable is submerged in water while you are charging, do not touch the Battery Charger or AC cable. Contact your servicing dealer.
- **DO NOT** leave the AC plug plugged into the electric outlet after you finish charging.
- **DO NOT** pull on the cable when you pull out the AC plug.
- **DO NOT** subject the Battery Charger to excessive physical shock, such as by dropping or hitting it.
- **DO NOT** use the Battery Charger to charge anything except authentic Battery Packs. Charging a non-authentic Battery Pack could damage it and the charger because of poor protection functions, etc.
- **DO NOT** touch the Battery Pack terminals with metal. Mishandling them could result in electric shock or fire, which may kill or seriously hurt you. Follow the procedures and instructions provided in the manufacturers manual.

BLADES

- **ALWAYS** remove the battery before changing the blade.
- **NEVER** install and use a blade other than those recommended by Altrad Belle.
- The rated speed of the blade needs to match the power tool's maximum speed, at the very least.
- **ALWAYS** use a blade designed for that particular application.
- **NEVER** use a damaged blade. Inspect the blade before operating the tool.
- **NEVER** use a worn-down blade designed for a larger rated tool.

TRANSPORTATION AND STORAGE

Before you move the machine, always:-

- Remove the battery from the machine.
- Keep hands clear of the switch.

Before you put the machine into storage, always:-

- Remove the battery pack from the machine.
- Make sure to clean the machine before storage.

Make sure that the storage area is:-

- Not available to children.
- Away from agents which can cause corrosion, such as garden chemicals and de-icing salts.

WEATHER CONDITIONS

- We recommended that this machine not be used in heavy rain.
- Rain can alter the condition of the worksite surface area. **ALWAYS** be aware of the condition of the surface after it has rained.
- Operating the machine in poor visibility can result in serious injury or even death. **ALWAYS** use lighting to improve the visibility of the area.
- **NEVER** operate the machine in temperatures below 5°C (41°F) or above 40°C (104°F)

DURING MAINTENANCE

- **ALWAYS** remove the battery before carrying out any maintenance on the machine.
- Carry out maintenance and repair work only if the machine is positioned on stable and level ground and has been secured against inadvertent movement.
- **NEVER** service the machine while the power unit is running, always switch **OFF** and remove the battery.
- Clean the machine before carrying out maintenance/repair.
- **DO NOT** use strong solvents or detergents on the plastic housing or components.
- When dismantling assemblies containing components under pressure from springs, always wear suitable PPE. This will protect against eye injuries from accidental flying components.
- When handling oil, grease and other chemical substances, observe the product related safety regulations.

AFTER MAINTENANCE

- **ALWAYS** tighten any screwed connections that have been loosened during maintenance and repair.
- Any safety devices removed for set-up, maintenance or repair purposes must be refitted and checked immediately upon completion of the maintenance and repair work.
- **ENSURE** that all consumables and replaced parts are disposed of safely and with minimum environmental impact.

MODIFICATIONS & REPLACEMENT PARTS

- **NEVER** make any modifications or additions to the machine without the prior approval of Altrad Belle. Any unapproved modifications may affect the performance and safety of the machine. This may also void the Warranty.
- **ALWAYS** use genuine Altrad Belle replacement parts. Use of non-genuine replacement parts may affect the performance and safety of the machine. This may also void the Warranty.

Genuine Altrad Belle replacement parts can be purchased online at www.Altrad-Belle247.com



WARNING!

The life of the operator can be at risk whilst operating this product. Take care and use the product correctly.

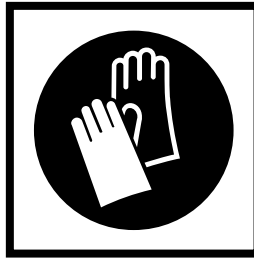

Wear protective gloves!



Please read Operator's Manual!

Ensure you understand the instructions before operating this product.



NEVER use a damaged blade!

Using a blade that has cracks or others damage may cause fatal injuries to the operator or



Risk of fire or explosion!

Sparks from the cutting process may cause fire in nearby explosive materials.

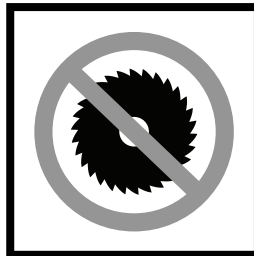

NEVER use a circular saw blade!



Risk of dust inhalation!

Dust may be produced during the cutting process. Use recommended respiratory protection and ensure adequate ventilation.

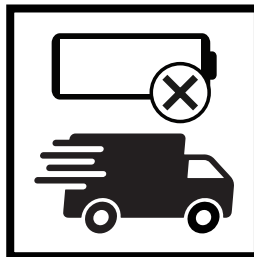

Remove battery before transporting!

The battery must not be left in the machine during transportation. This could cause a fire or explosion.

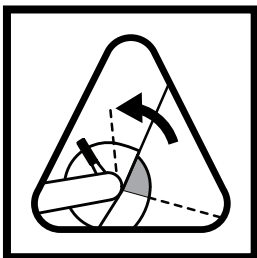

Risk of kickbacks!

The cutting process may cause kickbacks that could result in injury or death. Read and understand this manual prior to operating the machine.

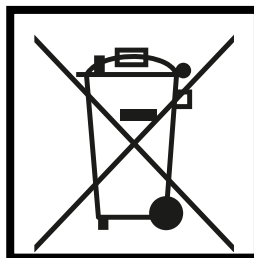

WEEE Logo!

This product should not be discarded as unsorted waste but must be sent to separate collection facilities for recovery and recycling.



Wear a protective helmet!

Wear eye protection!

Wear ear protection!

Wear a protective mask!



Wear protective footwear!



WARNING

Before you operate or carry out any maintenance on this tool **YOU MUST READ** and **STUDY** this manual.

CHARGING THE BATTERY PACK



CAUTION

The battery pack is not shipped fully charged. It is recommended to fully charge before use to ensure that maximum run time can be achieved.

- Only charge compatible batteries with the charger.

NOTE: ALWAYS allow the battery to complete 5 charge cycles (A cycle is defined as 100% - 0% - 100%) to enable the battery to reach its optimum capacity

1. Plug the power lead into the charger body.
2. Connect the power lead plug into a suitable rated mains power supply socket.

NOTE: This charger should only be used on 230v AC 50/60Hz supply with a minimum load current of 10A

3. Use the battery charger indoors only and away from any damp environments.
4. Place the charger on a flat surface and do not obstruct any ventilation slots.
5. Do not use the charger in any explosive atmospheres and keep away from combustible powders, water sprays or metallic dust or shavings.
6. Slide the battery into the slot of the charger ensuring that the battery contacts are aligned with the charging connection blades.
7. Gently push the battery firmly into the charger slot.
8. Switch the power outlet on.
9. Check the indicator LED (C or D).

Flashing Green = Charging (Leave battery on the charger until LED shows solid Green)

Solid Green = Battery charged (Battery charged, remove battery from charger)

Solid Red = Battery over temperature [Battery caution logo] (Leave the battery on the charger for up to 30mins until the LED flashes Green)

Flashing Red = Battery fault (Remove battery and dispose of correctly)

10. The battery will only start charging if the charge level is below 69%.

- See also the manufacturers instruction card supplied with the charger.

INSTALLING THE BLADE**CAUTION**

The arrows on the blade guard indicate the direction of rotation. **ENSURE** the blade is fitted in the same direction.

1. Press and hold the spindle lock button (Item A).
2. Remove the blade clamping plate (Item B) and blade securing screw (Item C).
3. Place the blade (Item D) onto the shaft sleeve (Item E), followed by the blade clamping plate and blade securing screw.
4. Tighten the screw to 25Nm.

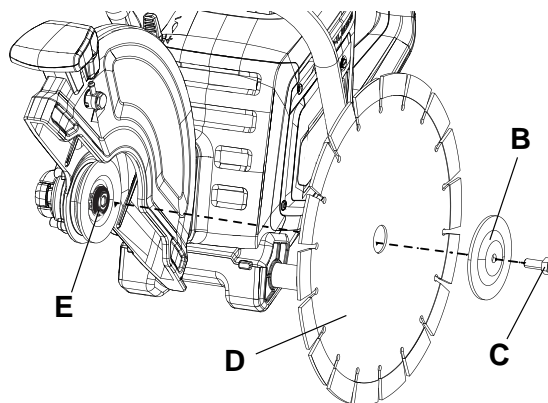
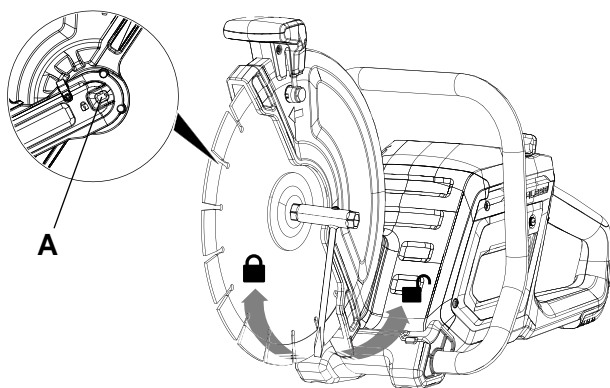
**ADJUSTING THE BLADE GUARD**

The blade guard can be adjusted to different angles to suit various applications. To do so, follow these instructions:-

1. Pull the guard adjustment lever (Item F) backwards and hold it.
2. Move the guard to the desired angle.
3. Release the guard adjustment lever.

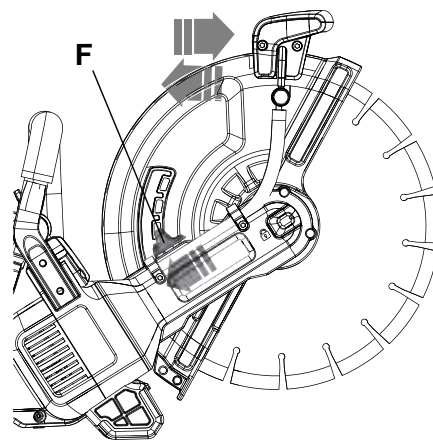

**CAUTION**

Stop the machine and wait until the motor stops before you install or remove the battery pack.

INSERTING THE BATTERY

1. Select a compatible battery (Item A) and check that it is in good operational condition. If the battery shows signs of impact damage, emits an unusual smell, feels hot **DO NOT USE**
2. Check the charge value by pressing the 'charge indicator' button. If the battery charge is sufficient then proceed to insert the battery into the motor housing.
3. Align the lift ribs on the battery with the grooves in the battery compartment.
4. Push the battery into the battery compartment until the battery locks into place.
5. When you hear a click, the battery is installed.

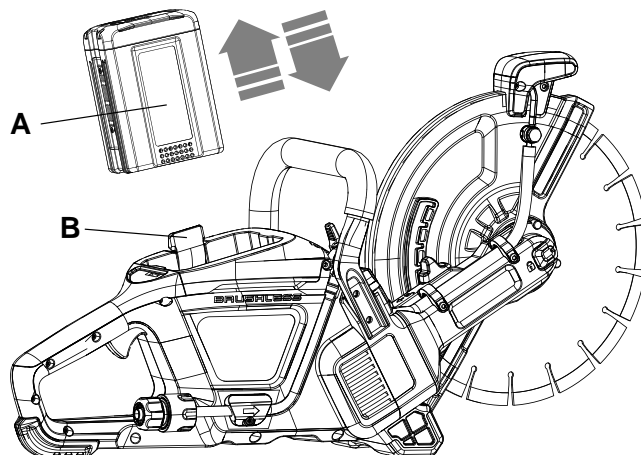
**REMOVING THE BATTERY**

1. Push and hold the battery release latch (B).
2. Remove the battery pack from the machine.

FUNCTION OF CONTROL PANEL**ON/OFF Button (Item C)**

- 1 push = power on/off.
- 1 minute delay of inactivity = power turns off .
- If light is on. 1 minute delay of inactivity = stand by.

LED Light On / Off Button (Item D)

- When power is on, 1 push = light on/off .
- 10 minutes delay of inactivity = light turns off .
- During the last minute of delay, flashes will occur before light turns off.

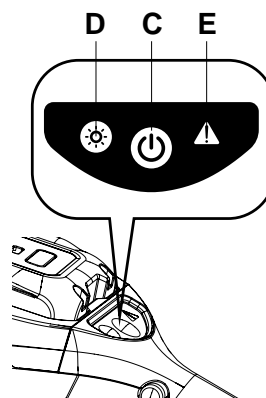
Warning Light (Item E)**HOLDING THE MACHINE**

1. Hold the machine with one hand on the rear handle (Item F) and with the other hand on the front handle (G). **ALWAYS** use both hands when operating the machine.
2. Hold the handles with the thumbs and the fingers around them.
3. Make sure that the thumb of the hand that holds the front handle is below the handle.

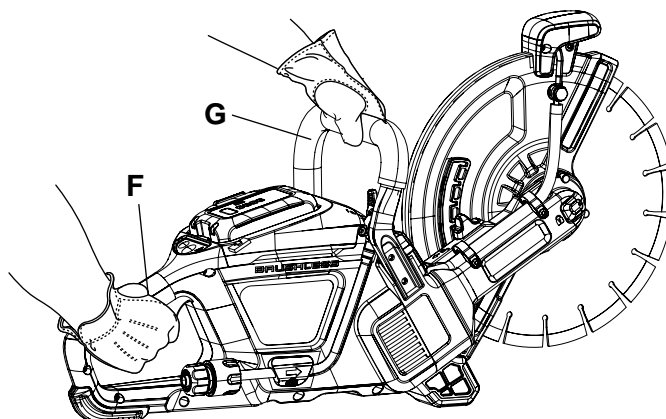

CONNECT THE WATER SUPPLY**WARNING** Wet cutting is only required with the diamond blade when cutting concrete.**CAUTION** In sub-zero temperatures, the water must be drained from the pipe after finishing work to avoid the risk of freezing.

1. Connect the water supply hose to the water feed coupling (E).
2. Re-connect water feed coupling to the machine.
3. Adjust the water flow using the water flow valve (F).
After completing the work, stop the machine and close the water supply.
4. Disconnect the water supply hose from the water feed coupling.

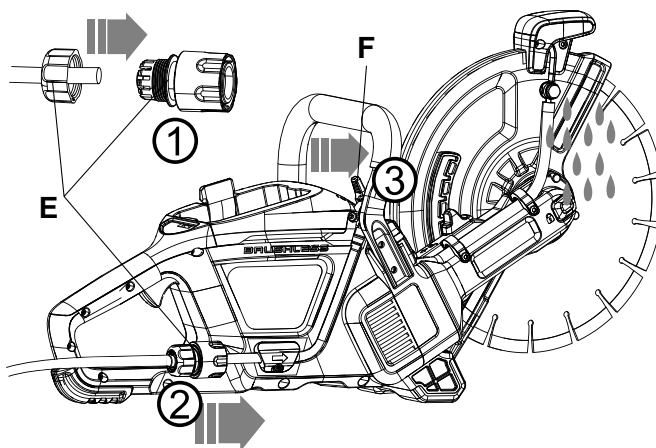
**CAUTION** **DO NOT** continue to cut after stopping the water supply. The concrete dust produced during cutting can block the water outlet.**TRIGGER LOCK-OUT BUTTON**

The disc cutter is equipped with a trigger lock-out button that prevents accidental operation.

Once you have gripped the rear handle (Item A), the trigger lock-out button (B) needs to be depressed to release the trigger (C) allowing for operation.

If the trigger is released, the trigger lock-out button will need to be depressed again to release the trigger.

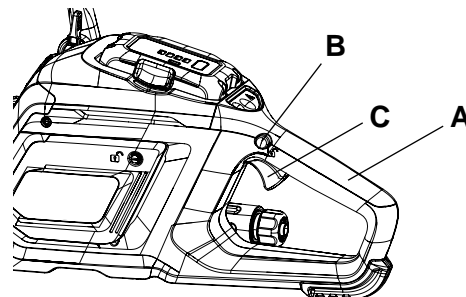
**WARNING** **Danger of kickback!!** Kickback can result in fatal injuries. Kickback occurs when the machine is suddenly thrown up and back in an uncontrolled arc towards the operator.**STARTING THE MACHINE**

1. Press the on / off button (Item D).
2. Press the trigger lock-out button (E).
3. Press the trigger (F) while you hold the lock-out button.

STOPPING THE MACHINE

1. Release the trigger to stop the machine.
2. Press the on / off button.

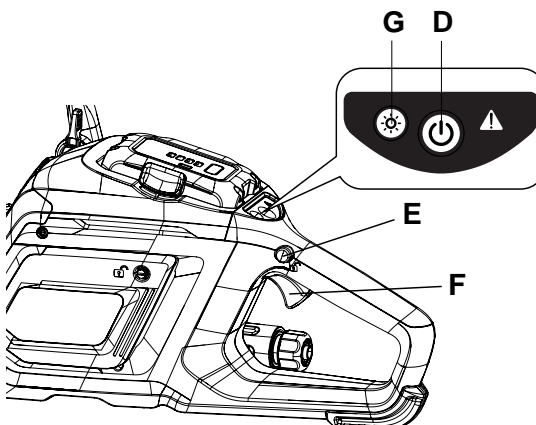



CAUTION

Stop the machine and wait until the motor stops before you install or remove the battery pack.



CAUTION

To prevent injuries from kickback, the disc cutter should **ONLY** be operated by competent users.



CAUTION

ENSURE extra care is taken when placing the blade into an existing cut.

OPERATING PRINCIPALS

Kickback

A kickback is an abrupt response to a spinning blade that has been pinched or snagged that causes the blade to stall rapidly, forcing the powered tool in the opposite direction of the blade's revolution, at the point of snagging.



WARNING

Kickbacks can be quite forceful and abrupt. The disc cutter has the potential to be pushed up and back towards the user, inflicting serious or even deadly injuries. Prior to using the product, it is essential to understand what causes kickback and how to prevent it.

Kickback Area

NEVER cut with using the kickback area of the blade. The disc cutter will rotate and push up and back towards the operator if the blade gets pinched or stalls in the kickback area. This could result in serious or even fatal injuries.

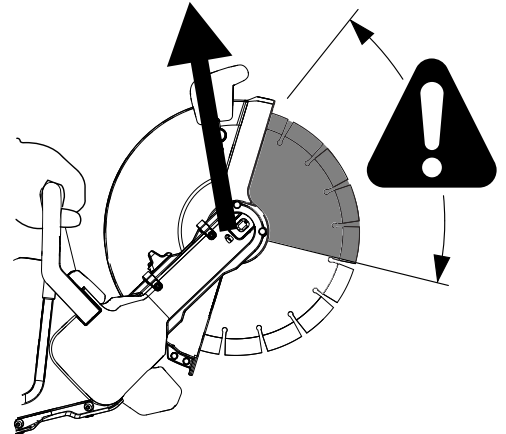

Pinching Kickback

When a cut closes, the blade becomes pinched. Reactive force will be high and you might not be able to control the disc cutter if the blade is pinched or stalled.

The disc cutter will rotate and push up and back towards the operator if the blade gets pinched or stalls in the kickback area. This could result in serious or even fatal injuries.

Keep an eye out for any possible movement of the work piece. The work piece may pinch the blade and kick back if it is not securely held and moves while you cut.

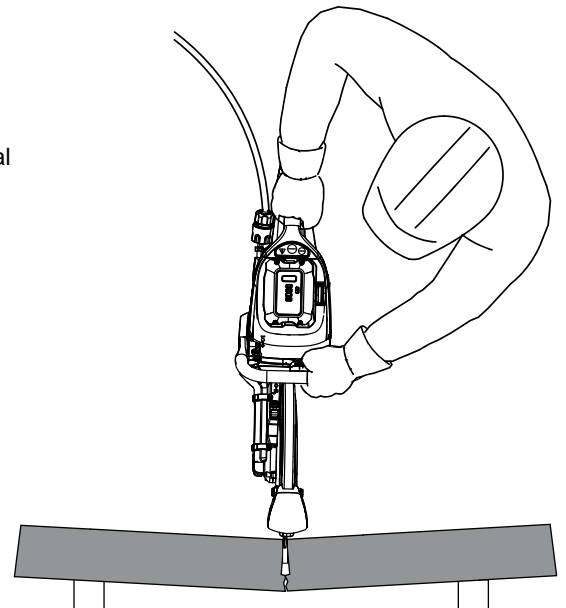



WARNING *ENSURE the work piece is not able to move during the cutting process.*

Pipe cutting

ENSURE special care is taken when cutting through pipes. If the pipe is not sufficiently supported and the cut kept open throughout the cutting process, the blade might become pinched. When cutting a pipe that has a belled end or a pipe in a trench, pay extra attention because the pipe may sag and pinch the blade if it is not securely supported.

If the pipe is allowed to sag and close the cut, the blade may be pinched in the kickback area causing a severe kickback to occur. If the pipe is supported correctly, the end of the pipe will move downward during the cutting process, the cut will open and no pinching will occur.

The pipe also needs to be secured to stop it moving or rolling during the cutting process. **ENSURE** the cut opens to avoid pinching the blade.

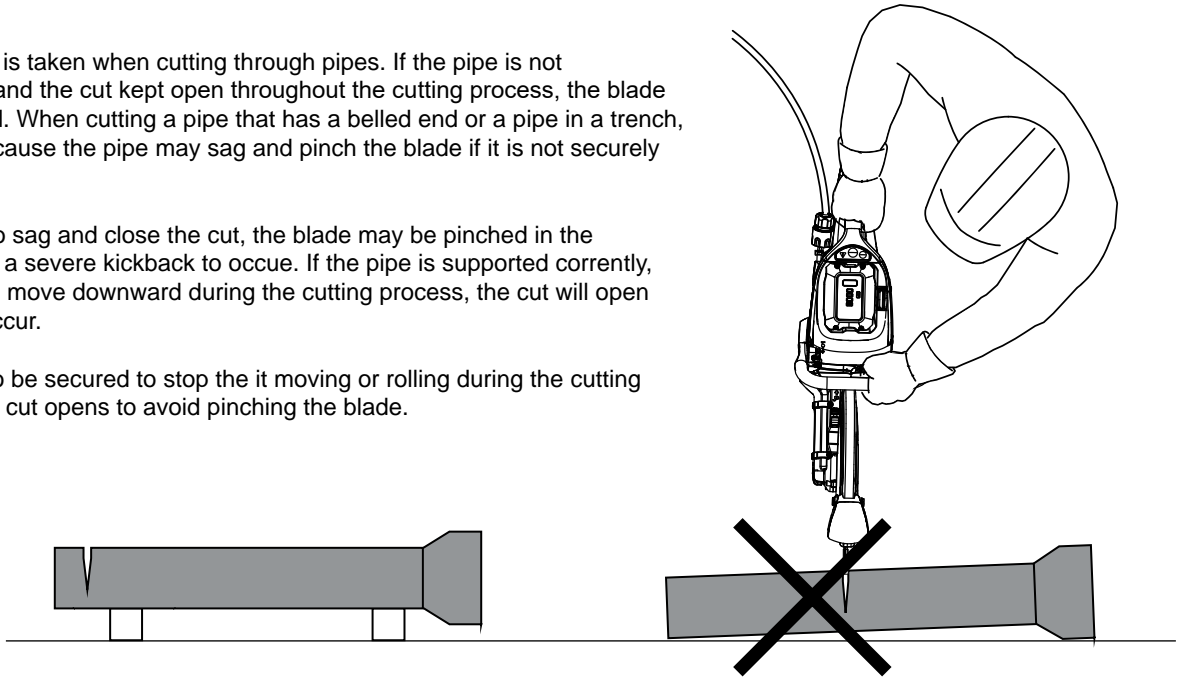

The maximum cutting depth of this disc cutter is 112mm, which is enough to cut through a standard 110mm soil pipe with a single cut.

If cutting through a pipe that is smaller than the maximum cutting depth, always cut from top to bottom.

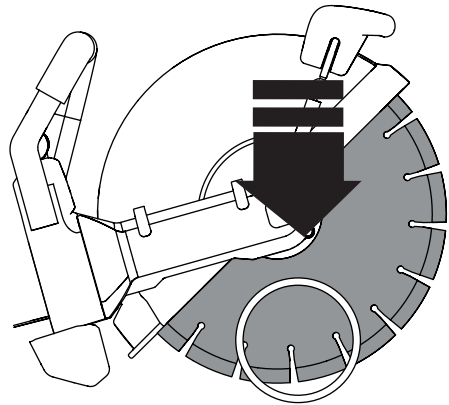

LED LIGHT

The LED light illuminates when the LED light on / off button (A) is pushed. It provides extra light for increased visibility.

1. With the machine switched on, press the light button to turn on the LED light.
2. It can light up the work area and provide a cutting line.
3. Press the light button again to turn off the LED light.

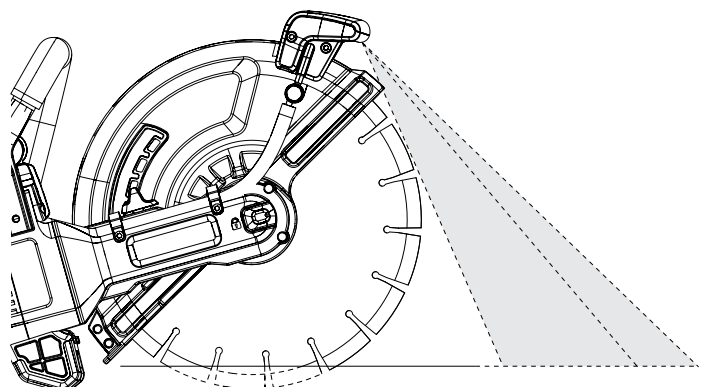
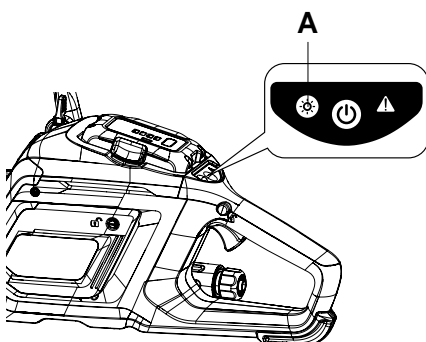

If the machine is not to be used for an long period of time it must be stored correctly to prevent deterioration or damage occurring during this period.

Store the machine in a clean dry building with plenty of ventilation if possible. If you can only store outdoors, cover with a waterproof sheet / tarpaulin.

PREPARING THE MACHINE FOR STORAGE

1. Clean the machine and remove all unwanted material / debris (See the Cleaning section on page 24).
2. Dry the machine to remove any moisture.
3. Apply grease to any moving parts / grease points.
4. Examine the machine for any worn / damaged parts. Replace if necessary.

STORING THE MACHINE

1. Place the machine safely on stable, level ground inaccessible to children.
2. **ENSURE** the battery pack is removed and stored in a clean, dry area.

DURING STORAGE

To prevent the build up of rust and to minimise the risk of seizures, periodically operate all machine functions during storage.

1. Install a fully charged battery.
2. Start the machine.
3. Operate the machine to **ENSURE** it operates correctly.
4. Re-do storage procedure from above.

REMOVING THE MACHINE FROM STORAGE

1. Install a fully charged battery.
2. Carry out the Pre-Start Check procedure (See page 9)
3. Operate the machine as per the operating instructions in this manual.

Environment



Safe Disposal.

Instructions for the protection of the environment.

The machine contains valuable materials.

Take the discarded apparatus and accessories to the relevant recycling facilities.

Component	Material		Component	Material
Blade	Steel		Battery Housing	ABS Plastic
Drive Arm Casing	Zinc Aluminium		Buttons/ Latches	Polypropylene Plastic
Drive Gears	Steel		Motor	Steel, Magnets - Aluminium
Blade Guard	Zinc Aluminium		Wiring	Copper/ PVC coated
Main Housing	Zinc Aluminium		Springs	Steel
Main Body	ABS Plastic		*Battery Pack	*See Below
Top Cover	ABS Plastic		*Battery Charger	*See Below

***DO NOT** dispose of electric equipment together with household waste material.

If electrical appliances are disposed of in landfills or dumps, substances can leak and react and enter into the food chain, damaging your health and well-being. For further information on the disposal of this product, please contact your dealer or your nearest domestic waste collection service.



WARNING

Before starting any maintenance or repairs, switch off the motor and remove the battery.
On completion of maintenance, check that all guards are correctly fitted and the machine functions correctly.

GENERAL

This machine is designed to give many years of trouble free operation. It is, however, important that the simple regular maintenance listed in this section is carried out. All maintenance procedures must be carried out by a competent, suitably qualified person.

A poorly maintained machine could be a danger to the operator and the other personnel on the worksite. **ENSURE** that the regular maintenance procedures listed in this manual are performed correctly and on time to keep the machine safe and efficient.

ALWAYS use genuine Altrad Belle replacement parts, the use of spurious parts may void your warranty.

Before any maintenance is carried out on the machine, switch off the machine and **ALWAYS** set the machine on stable, level ground.

ENSURE any faults identified during maintenance procedures are addressed and corrected immediately.

MAINTENANCE SCHEDULES

Routine Maintenance		Maintenance Interval		
		Before Use	After Use	Monthly / 20 Hrs
External areas of the product	Clean	✓		
Internal areas of the product	Clean (Compressed air)			✓
Trigger / Trigger Lock Out	Check Function	✓		
Diamond Blade	Check Condition	✓		
Blade Guard	Check Condition	✓		
Magnet Filter	Clean		✓	
Fan Housing	Clean	✓		
Screws and Nuts	Check Tightness	✓		
Control Panel	Check Function	✓		
Battery / Product Connection	Check Function			✓
Safety / Warning Decals	Check Condition	✓		
Damaged Parts	Replace	✓	✓	

CLEANING

Keeping the machine clean is an integral part of the service and maintenance program. The build-up of dust, dirt and debris could potentially affect the operating safety of the machine, exposing both the operator and other personnel to potentially hazardous situations.



WARNING

NEVER use a hose or pressure washer to spray water on the machine while cleaning it. Water entering the internal components may cause a malfunction and/or injury.

- **ALWAYS** remove the battery pack from the machine before cleaning.
- Check and clean the magnet filter (Item A) after every working shift cutting metal.
- Wipe off any external material. **ALWAYS** wipe the battery pack clean with a dry, clean cloth. Before cleaning the battery pack, remove it from the specified device or the battery charger.
- **DO NOT** use petrol, turpentine, lacquer or paint thinner, dry cleaning fluids or similar aggressive detergents or solvents.
- **NEVER** let any liquids near the motor.
- Keep the air vents clean and free of debris to avoid overheating and damage to the motor or the battery.

After the cleaning process check that all connections and fasteners are in place and secure. Replace any if necessary.

Also **ENSURE** that all safety / warning decals are present in their correct locations. Replace any if necessary.

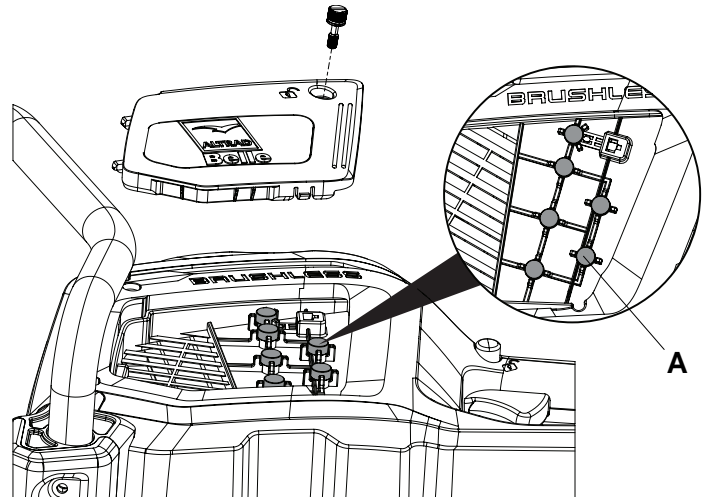

REPLACING THE BLADE



CAUTION

The arrows on the blade guard indicate the direction of rotation. **ENSURE** the blade is fitted in the same direction.



CAUTION

ONLY use approved, genuine replacement blades.

1. Stop the machine and ensure the blade has finished rotating.
2. Remove the battery
3. Press and hold the spindle lock button (Item A).
4. Remove the blade clamping plate (Item B) and blade securing screw (Item C).
NOTE:- The machine applies to two sizes (20mm / 25.4mm) of blade bore. You can change to the other size by turning over the shaft sleeve.
5. Fit the new blade (Item D) onto the shaft sleeve (Item E), followed by the blade clamping plate and blade securing screw.
NOTE:- Ensure the faces of the blade and clamping plate are clean & free from debris.
6. Tighten the screw to 25Nm.

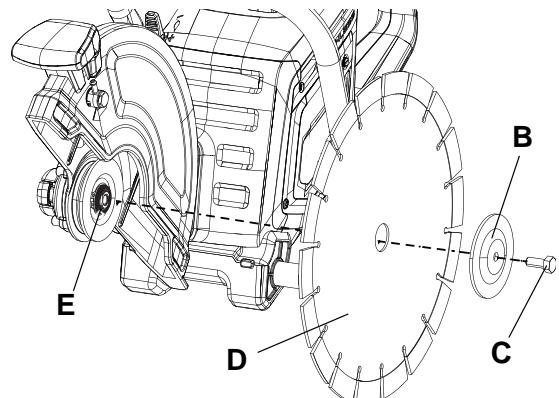
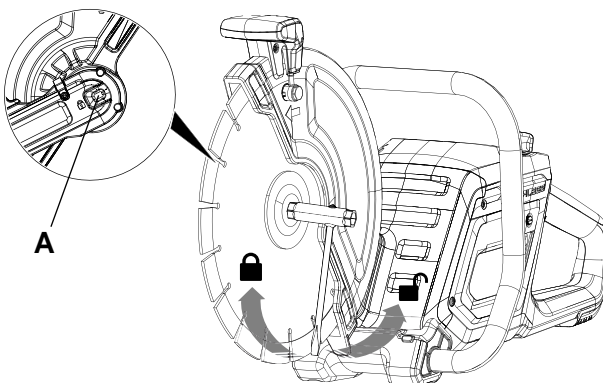

Problem	Cause	Remedy
The motor runs but the blade does not rotate.	The blade is too loose.	Make sure the screw is tightened with correct torque (See figure 3).
	The blade is damaged and can not rotate.	Check the blade guard and remove unwanted material after that see if the blade runs free.
	The motor or driveline is damaged.	1. Remove the battery pack from the machine. 2. Remove the wheel. 3. Clean the machine. 4. Install battery pack and operate the machine. 5. Call service center if the fault appears again.
The motor runs and the blade rotates, but it does not cut.	The blade is blunt.	Replace the blade.
	The blade is fitted the wrong way around.	Follow the blade fitting instructions.
	The blade is loose.	Make sure the screw is tightened with to 25Nm.
The machine does not start.	The machine and battery are not connected correctly.	Make sure that the battery release button clicks when you install the battery.
	The battery level is low.	Charge the battery.
	The battery is too hot or too cold.	Refer to battery and charger manual.
Warning light (Item A) flashes once.	Motor low speed protection	Release the trigger and start the machine again.
Warning light flashes twice.	Self-test failure of controller	1. Install the battery pack again.
		2. Replace the controller if the fault appears again.
Warning light flashes 3 times.	Battery pack communication failure.	1. Install the battery pack again.
		2. Replace the controller if the fault appears again.
Warning light flashes 4 times.	Overcurrent protection.	Release the trigger and start the machine again.
Warning light flashes 5 times.	Low-voltage protection.	Charge the battery pack.
Warning light flashes 6 times.	Controller overtemperature protection.	Cool the controller to ambient temperature.
Warning light flashes 7 times.	Blocking protection or communication failure of all sensors	1. Release the trigger and start the machine again.
		2. Replace the controller if the fault appears again.
Warning light flashes 8 times.	Switch logic error.	1. Release the trigger and start the machine again.
		2. Replace the controller if the fault appears again.
Warning light flashes 9 times.	Software authentication error.	1. Release the trigger and start the machine again.
		2. Replace the controller if the fault appears again.
Warning light flashes 10 times.	Motor over-temperature protection.	Cool the motor to ambient temperature.
Warning light flashes 11 times.	Battery temperature is too high.	Cool the battery pack to ambient temperature.

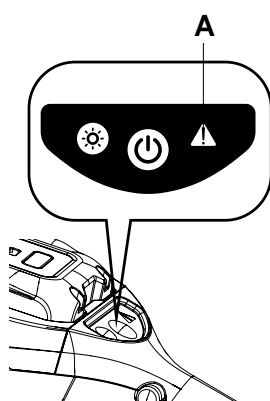

Your new Altrad Belle 'DC 300E+' disc cutter is warranted to the original purchaser for a period of two years (24 months) from the original date of purchase. The Altrad Belle warranty is against defects in design, materials and workmanship.

The following are not covered under the Altrad Belle warranty:

1. Damage caused by abuse, misuse, dropping or other similar damage caused by or as a result of failure to follow assembly, operation or user maintenance instructions.
2. Alterations, additions or repairs carried out by persons other than Altrad Belle or their recognised agents.
3. Transportation or shipment costs to and from Altrad Belle or their recognised agents, for repair or assessment against a warranty claim, on any machine.
4. Materials and/or labour costs to renew, repair or replace components due to fair wear and tear.

The following components are not covered by warranty.

- Blades.

Battery & charger are warranted to the original purchaser for a period of for 1 year (12 months) from the original date of purchase.

Please also consult the Battery & Battery Charger manuals for further information on their warranty details.

Altrad Belle and/or their recognised agents, directors, employees or insurers will not be held liable for consequential or other damages, losses or expenses in connection with or by reason of or the inability to use the machine for any purpose.

Warranty Claims

All warranty claims should firstly be directed to Altrad Belle, either by telephone, by Fax, by Email, or in writing.

For warranty claims:

Tel: +44 (0)1298 84606

Fax: +44 (0)1298 84073

Email: warranty.dept@altrad-belle.com

Write to:

Altrad Belle Warranty Department,
Sheen, Nr. Buxton,
Derbyshire,
SK17 0EU
England.

Warranty Registration:

In the bid for Altrad Belle to become greener and more eco friendly, we have now introduced online Warranty registration. To access the registration page of our website, please use the following address:-

http://www.bellegroup.com/index.php?p=warranty_registration

Alternatively, please scan the adjacent QR Code (Quick Response Code) using your smartphone to access the registration page.





BELLE
LIGHT
CONSTRUCTION
EQUIPMENT

ALTRAD BELLE

Sheen, Nr. Buxton, Derbyshire, SK17 0EU, GB

Tel. +44 (0)1298 84606 - Fax +44 (0)1298 84722 - Email: sales@altrad-belle.com

www.Altrad-Belle.com

EU IMPORTER ADDRESS

ADRESSE DE L'IMPORTATEUR - DIRECCIÓN DEL IMPORTADOR - ENDEREÇO DO IMPORTADOR - ADRES IMPORTEUR

IMPORTØRENS ADRESSE - IMPORTEUR ADRESSE - INDIRIZZO DELL'IMPORTATORE - IMPORTÖRENS ADRESS - IMPORTØRADRESSE

MAAHANTUOJAN OSOITE - ADRES IMPORTERA - IMPORTIJA AADRESS - IMPORTËTÄJA ADRESE - IMPORTUOTOJO ADRESAS

ADRESA DOVOZCE - ADRESA IMPORTATORULUI - IMPORTÓR CÍME - ADRESA UVOZNIKA - İTHALATÇI ADRESİ - ADRESA DOVOZCU

ALTRAD (Group Holding)

125, Rue du Mas Carbonnier, 34000, Montpellier, France

Tel. +33 (0) 4 67 50 53 66 - Email: admin@altrad.com

www.altrad.com